



"Be The Best You Can Be"

Weekly Newsletter

2025/26

Issue Number: 15

Date: 09/01/26

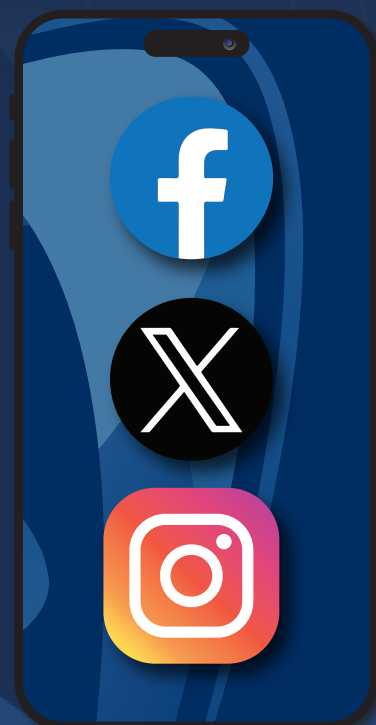

As we return to school this term, I would like to begin by thanking students and staff for the positive way we ended last term. It was a genuinely lovely and uplifting few weeks, with a strong sense of community across the school. From our 12 Days of Christmas initiative, to the wide range of personal development events and rewards opportunities, and the Year 7 and Year 8 Winter Celebration events, it was wonderful to see students engaged, confident and enjoying school life.

It was also particularly heartening to see so many students going out of their way in the final weeks before the Christmas break to support a range of charitable causes. Their generosity, kindness and willingness to help others are a powerful demonstration of altruism in action and reflect the values we work hard to instil at The Abbey School.

I am also pleased to share that the former Old Girls' Gym has now been successfully converted into a new Performing Arts and Assembly space. This development will significantly increase curriculum opportunities in drama, music and performance, and we expect it to further enhance student engagement, creativity and confidence across the school.

In addition, we currently have a planning application submitted for an additional 3G pitch on our site. If approved, this will further strengthen our sporting provision, enhance opportunities for students, and deepen our links with the local community by encouraging adults and community groups to step over the threshold and engage positively with our school.

Looking ahead over the coming days, there are some exciting opportunities for our students. We look forward to welcoming families to the Year 10 Subject Consultation Evening on Thursday 22nd January, supporting students as they make important decisions about their next steps. We are also delighted that a group of students will be attending the Wicked theatre trip on Wednesday 14th January, accompanied by Miss Nunn, providing a fantastic cultural experience linked to our Performing Arts offer.

As we move into the new term, regular attendance remains a key priority. We know that getting up early on cold, dark winter mornings can be challenging, particularly after the festive break. However, being in school every day makes a significant difference. Strong attendance is closely linked to better learning, stronger progress, positive routines and improved wellbeing. Every lesson missed is learning that cannot be fully replaced.

For our Year 11 students, this term is especially important as they enter the final phase of their GCSE courses. Period 6 lessons are a vital part of the curriculum, offering targeted teaching, revision and support to help students consolidate learning and close any gaps. Full attendance at Period 6 will play a key role in securing the excellent GCSE outcomes that we know this cohort is capable of achieving.

Thank you, as always, for the continued support of our families. By working together, we can ensure that every student attends well, feels supported and is able to succeed.



Dr R Speller
Principal



BOOK A TOUR TODAY!

Choosing the right school for your child is one of the most important decisions you'll make. At The Abbey School, we provide a supportive, inclusive, and high-achieving environment where every student is encouraged to reach their full potential.

What You Can Expect to See on Your Visit:

- Engaging Lessons & Inspiring Teaching – See our dedicated staff in action, delivering high-quality education.
- Excellent Facilities – Modern classrooms, specialist subject areas, a well-equipped sports hall, and vibrant social spaces.
 - Strong Pastoral Care – A nurturing and inclusive community where every child is supported.
 - Enriching Opportunities – A variety of clubs, trips, and extracurricular activities that enhance learning and personal development.
- A Safe and Welcoming Environment – High expectations, respect, and ambition at the heart of everything we do.

Accessibility & Inclusivity

We are committed to making The Abbey School accessible for all visitors. Our site offers:

- Step-free access and wheelchair-friendly pathways.
 - On-site parking, including accessible bays.
- Easily accessible location with good transport links.

Come and see The Abbey School in action! Book a tour today and experience first hand why we are the perfect choice for your child's future.

If your child has an EHCP and you would like a tour of the SRP, please can you contact Mrs Holliday to book this: kholliday@abbeyschoolfaversham.co.uk

CLICK THE QR CODE BELOW TO BOOK YOUR TOUR!



Uniform Sale!



A message from Forsters School Outfitters:

We know also many parents are feeling the pinch after so much spending and for this reason and to beat the blues, we have decided to give 10% off on all School Clothing; this includes Jumpers, Cardigans, Fleeces.

This offer is also extended to Staff School wear, and last but not least on School Leavers Products: Hoodies, Polos and T Shirts.

Please spread the word as time is of the essence. The code is simply enter the code JANBLUE26 at checkout on our website and parents can receive a 10% discount on their order.

#BeTheBestYouCanBe



STUDENT SHOUTOUT!

Evie W is a member of Stagecoach Performing Arts and after attending rehearsals for five months, she performed in a very modern version of Annie at the West End's Shaftesbury Theatre on 14th December.

Evie was absolutely thrilled to be part of such an incredible opportunity and performed to the highest standard, taking centre stage for parts of the performance. She loved every second!

Performing on stage is her happy place, and she is always striving to be the best she can be, with hopes of one day securing a career on stage. As a family, we are unbelievably proud of her. She always gives her all, works to a very high standard and makes her group leaders, fellow students and her family extremely proud.

Well done Evie!



**The Abbey
School**

Year 10

PARENTS' EVENING

**Thursday 22nd January
4.30 - 7.00pm**

**This is a fantastic opportunity
for parents and carers to meet
with your child's teachers.**

- See your child's progression
- Target advice
- Discuss future pathways

**You may also choose to speak
with:**

- The Head of Year 10
- The Attendance Team
- The Safeguarding Team
- Senior Leaders

We look forward to welcoming you.

☎ 01795 532633

✉ info@abbeyschoolfaversham.co.uk

London Road, Faversham, Kent ME13 8RZ



THE WORRY BOX



Checked daily during school hours
www.theabbey-that.org.uk/worrybox

Not checked at the weekends or evenings. For urgent help, contact
NSPCC, Action for Children or Childline



STUDENT SHOUTOUT!

We love celebrating our amazing students and their achievements! Parents and carers, we'd love to hear from you! If your child has achieved something they're proud of (big or small!), send it in and we will share this with our school community.

Achievements could include:

- Academic successes
- Sporting achievements
- Creative talents
- Personal milestones
- Acts of kindness or resilience

To take part, simply email us with:

Your child's achievement
Their name
A photo (optional)

info@abbeyschoolfaversham.co.uk

Let's work together to celebrate our students and recognise their hard work!

#BeTheBestYouCanBe

WELCOME TO THE ABBEY SCHOOL

Click the image below to view our brand new promotion video!



Growing Together in Kindness

We would like to remind parents and carers of who we are and what we stand for. We are proud to be an integral part of the Faversham community - some of our students' families have roots here going back generations. Though our buildings, uniforms, and staff may have changed over time, our core values remain steadfast and we believe they always will.

We are a school that lives by our motto: "Be the Best You Can Be." As a dedicated team, we strive to nurture in our students a strong sense of character and purpose. We promote values such as aspiration, curiosity, integrity, persistence, altruism, creativity, resourcefulness, and reflection - and, perhaps most importantly in today's world, a deep commitment to community and responsibility.

We teach our students to treat others with respect and compassion, regardless of background. Everyone deserves to feel they belong - no matter their race, nationality, religion, sex, gender, age, disability or any other aspect of their identity.

At The Abbey School, we see diversity and inclusion as strengths to be celebrated. Our aim is to prepare students not only for academic achievement but to become kind, empathetic individuals who make a positive difference in the world. Because in the end, isn't it kindness that matters most - that we look out for one another, no matter our differences?



SCHOOL CLOUD

We are pleased to announce that for future parents' evenings, we will be using a new system called School Cloud.

This system will allow you to book all your appointments with your child's teacher online, rather than your child booking them in person. This should make the process much easier and more convenient for everyone.

Further info will follow!



BOOK OF REMEMBRANCE

The Abbey School received a wonderful gift from Stephen Palmer, a War Memorials Register Volunteer with the Imperial War Museum.

Stephen generously presented us with a Book of Remembrance, a remarkable collection that tells the stories of local men who lost their lives in war. The book also includes photographs and personal details that help bring these stories to life.

We are incredibly grateful for this thoughtful donation, which will serve as a lasting reminder of the bravery and sacrifice of our local heroes.

Below is the link for the book!



You can make a difference!

Are you passionate about making a difference in education and shaping the future of young learners? The Abbey School is seeking a dedicated **Parent Governor** to join our board and help support our school community.

Interested in joining us?

Email: sphillipson@thatrust.org.uk



Become a Parent Governor

- Help shape meaningful decisions that truly impact young lives.
- Grow and develop new skills in a rewarding role.
- Be part of a supportive organisation that truly makes a difference.
- Help us remove barriers to education.

Email: sphillipson@thatrust.org.uk

What we offer:

- Enjoy a flexible commitment that fits around your schedule.
- Access comprehensive support and training to help you thrive in your role.
- Take advantage of valuable professional development opportunities.



ATTENDANCE MATTERS



TIME LOST DUE TO LATENESS

AMOUNT	MINS LATE	HOURS MISSED END OF SCHOOL YEAR	SCHOOL DAYS LOST
1 LATE PER WEEK	10	6.5 HOURS	1.3 DAYS
2 LATES PER WEEK	10	13 HOURS	2.6 DAYS
3 LATES PER WEEK	10	19.5 HOURS	3.9 DAYS
4 LATES PER WEEK	10	26 HOURS	5.2 DAYS
5 LATES PER WEEK	10	32.5 HOURS	6.5 DAYS

Secondary School of the Year

Recognising the exemplary use of STEER to proactively safeguard children and young people, and your role in supporting proactive safeguarding across your sector.

2025



Simon Walker
STEER Founder



**The Abbey
School**



Jo Walker
STEER Founder

SENECA CHAMPIONS

Well done to our Seneca Champions from this week!

Year Group	Learning Time	Average Score	Time Champion	Score Champion
12 & 13	15h 17min	87%	Oliver S	Oliver S
11	49h 10min	71%	Daisy Thorne	Lily P
10	21h 20min	72%	Ariana S	Joshua T-S
9	65h 58min	61%	Kieron B	Roxie R
8	11h 40min	65%	Gvidas A	Maxwell S F
7	30h 22min	62%	James K-F	Emily C

ONION SPACE

Help Us Create Onion Space

A mental health and wellbeing space, imagined by young people, for young people...

The Abbey School is working on an ambitious, student-led project called Onion Space - a dedicated mental health, wellbeing and nurture space designed to support our brilliant young people when they need calm, safety and care the most.

Onion Space was dreamt up by our House Council students as a way of giving back to their school community. They wanted to create something lasting, practical and compassionate, a space that recognises the pressures young people face and offers support, reflection and reassurance when it's needed most.

To bring this vision to life, we have been generously gifted an old blue minibus, which we plan to fully convert into a warm, welcoming, purpose-built wellbeing space on our school site.

Why "Onion Space"?

Onions are layered - just like people.

They remind us that:

- Everyone has layers beneath what we see
- It's okay to peel back gently, at your own pace
- Growth, healing and understanding take time and care
- Even things that make us cry can help us heal

This symbolism sits at the heart of Onion Space: a place that recognises the complexity of young people's lives and supports them with dignity, empathy and kindness.



What will happen to the minibus?

To make Onion Space safe, accessible and fit for purpose, the minibus requires a full refurbishment. Our ambition includes:

- Full interior strip-out and refit
 - Insulation, heating and ventilation
- Soft seating, calm lighting and sensory-friendly design
- Storage for wellbeing resources and peer-mentoring materials
- Electrical work (power, lighting and charging points)
- Exterior rebranding to reflect the Onion Space identity
- Accessibility and safeguarding adaptations

This is a significant conversion project, and the total cost to bring Onion Space to life is likely to be £25,000.

How can you help?

We would love this to be a whole-community Faversham project, built with the support, skills and generosity of local people and businesses.

We are looking for:

Financial support

- One-off or regular donations
 - Business sponsorship
- Corporate or community funding

Skills & practical support

- Vehicle conversion / coach-building
 - Carpentry or joinery
 - Electrical work
 - Plumbing or heating
- Upholstery or soft furnishings
- Interior or sensory-space design
- Painting, decorating or branding

Connections

- Introductions to local businesses or trades
 - Donated or discounted materials
- Fundraising or sponsorship opportunities

Get involved

If you are able to donate, volunteer skills, offer resources, or connect us with someone who can help, we would love to hear from you.

Please contact:

Dr Moseley
amoseley@abbeyschoolfaversham.co.uk



THE ABBEY LESSON

THE ABBEY CLOCK: HOW WE HELP STUDENTS LEARN WITH PURPOSE

At The Abbey School, every lesson follows a clear rhythm designed to help students remember more, understand deeply and make strong progress. This structure, known as The Abbey Clock, ensures the learning journey is consistent, ambitious and supportive for all students.

Starter Slide

At the start of each lesson, students connect previous learning to the new knowledge they will explore.

This moment helps them understand:

- What they are learning
 - Why it matters
- How today's learning builds on earlier content

Students are expected to:

- Write the date and Big Question/title
- Open their Knowledge Organiser on the correct page
- Listen carefully to understand "why this, why now"
 - Make links to prior learning

End Slide

The End Slide brings the lesson full circle.

Students:

- Reflect on what they've learned
- Check their understanding against the success criteria
 - Identify strengths
- Notice what they need to revisit or revise

This supports long-term progress and helps teachers respond quickly to learning needs.

Knowledge Organisers (KOs)
Knowledge Organisers sit at the heart of learning at The Abbey School.
Students must have them on their desks every lesson.

KOs help students retrieve key facts and vocabulary, complete home learning and prepare for assessments.

Every KO includes RAG boxes so students can traffic-light their confidence:

Red – I don't understand yet
Amber – I understand some parts
Green – I'm confident

Students use these RAG ratings to track what they know and what they need to revise or ask about. This builds independence and a clear sense of progress.

Stamps & House Points

During lessons, teachers circulate to check work and give quick, targeted feedback. Students receive stamps when:

Work has been checked
Effort is strong
Learning is accurate
Misconceptions have been addressed

To reward consistency:

3 stamps on a page = 1 House Point (KS3/4)
Stamps encourage effort, pride and progress, and help students build a clear record of their learning.

Together, these routines help every student learn with purpose, clarity and ambition, preparing them for life, not just exams.



THE ABBEY CLOCK

30



Shape



At The Abbey School we speak in full Sentences.



Our Hands are away from our faces when we speak.



We Articulate. We never speak too quickly or mumble.



We Project. We speak clearly and audibly to the whole class using our university voices.



We look people in the Eye to show confidence and respect.



Steps



Sir, Miss or Dr every time. We call this the Abbey full stop. It should end every sentence



Thank you, every time someone does something for us



Excuse me, every time you need to enquire or get attention. Then we wait and never interrupt



Please, every time that you request something



Style - the way we present ourselves matter, think about your body language, expression, tone and words



CALLING ALL POTENTIAL COMMUNITY OFFICERS



**DO YOU WANT TO MAKE A DIFFERENCE TO YOUR SCHOOL? DO YOU HAVE SOME GREAT IDEAS ABOUT HOW TO
BRING POSITIVE CHANGE?**

THEN APPLY NOW – WE WANT YOU!

Due to the retirement of some of our year 11 house officers, we are going to have a few spaces on the house council team. This is a team that does the following activities:

- Organises community events in the school, such as charity days
- Meets with Mrs LeBrunn-Healey and Mrs Lucas re positive change
- Gets involved in projects, such as Onion space and the White ribbon campaign
- Supports the school in fund-raising
- Collects and distributes documents and golden tickets
- Feedback to year groups in assemblies
- Helps organise trips and events, such as to Swale Council chambers
- Eco-projects – tree-planting and litter-picking

If you are interested in applying, you must do the following:

- 1) Let Dr Moseley know by **Friday 16th January**
- 2) Write a speech of no more than 2 minutes on the topic of: ***“One community project that I would like to propose and help run for the Abbey school is...”***

You will have 2 minutes to stand up in all house assemblies in week 6 of this term and give your speech to all year groups. Your speech will be judged on the following criteria:

- How well you outline your idea – is it clear how it would work?
- Why this idea is important and how it links to the community
- How well you present it – are you clear and concise?
- How can you get the school on board?

Successful candidates will then be informed and be in position for term 4. I will also be sending the list of potential candidates to your tutors and heads of year, so they can keep me informed of anything brilliant you do for the school/community before week 6 of this term. If you have any questions either email or see Dr Moseley –

amoseley@abbeyschoolfaversham.co.uk

ATTENDANCE MATTERS AT THE ABBEY SCHOOL

You may have noticed that we've have started using our new Attend system more regularly to communicate with you about your child's attendance. These updates are designed to keep you informed about your child's attendance percentage, celebrate positive attendance, and let you know how many more days are needed to reach the next attendance milestone.

Our goal is to make it easier for parents and carers to stay up to date and to identify any issues that may be affecting your child's attendance. If you have any concerns or circumstances you'd like us to be aware of, please don't hesitate to get in touch with our attendance team.

Attendance Contacts:

Miss L. Thomson (Attendance Manager) – lthomson@abbeyschoolfaversham.co.uk

Miss I. Streatfield (Attendance Officer) – attendance@abbeyschoolfaversham.co.uk

Miss K. Rickard (Attendance Officer) – attendance@abbeyschoolfaversham.co.uk

Attendance Golden Tickets

At The Abbey School, we love celebrating great attendance! Every student who attends school for a full week receives an Attendance Golden Ticket. Each ticket earns them an entry into our end-of-term prize draw, meaning the more full weeks they attend, the greater their chance of winning!

This term's prizes: Four lucky students will each win a £50 Amazon voucher — simply for being in school!

Remember: You've got to be in to win!

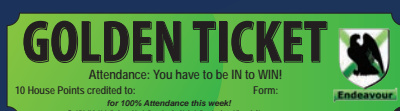
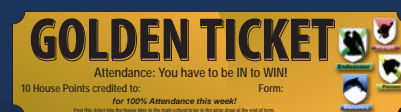
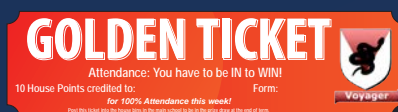

Weekly Attendance Rewards

We've listened to our students' feedback and have introduced more frequent, smaller rewards to recognise consistent attendance and progress toward individual goals. Each Friday during afternoon line-up, we'll hand out fun prizes such as pens, sweets, motivational notepads, squishes, and other treats!

Winners will be selected from those with 100% attendance for the week and students who have achieved their attendance milestone.

100% Attendance – End of Year Rewards

We're thrilled to announce this year's 100% attendance rewards! Students who achieve full attendance for the entire academic year will be entered into a special prize draw to win:

A brand-new PlayStation 5
A brand-new Laptop
A brand-new Tablet

We may even add more prizes later in the year!

We also recognise that some students have medical conditions that may require unavoidable absences for appointments. These students will still be included in our prize draws where appropriate.





Abbey School Sixth Form

Passionate about golf?
Join our Sixth Form and play alongside your studies!

Come and join our success story!



www.theabbey-that.org.uk

Faversham Golf
Academy



The Abbey
School



DOVER ATHLETIC FOOTBALL ACADEMY

IN PARTNERSHIP WITH THE ABBEY SCHOOL SIXTH FORM
FOOTBALL ACADEMY TRIALS

TUESDAY 17TH FEBRUARY 2026

IF YOU ARE INTERESTED IN ATTENDING THE TRIAL OR WANT TO FIND OUT MORE INFORMATION, PLEASE SCAN THE QR CODE BELOW AND FILL OUT THE FORM.



- Excellent coaching from UEFA A Licence Coaches
- Full time training whilst studying a full range of A Level or BTEC Courses
- Full Fixture Schedule played on Wednesday afternoons
- Represent Dover Athletic Football Club
- Play in the FA Youth Cup
- Compete in International Tournaments
- Excellent progression route

If you have any questions, please contact Academy Manager Mike Sandmann
msandmann@abbey-school-faversham.co.uk



YOU SAID WE DID

We have worked with you
listened to your ideas and made lots of changes
over the last few years.

You asked.....

"Can we wear PE kit on PE lesson days so we can spend more time in the lesson and less getting changed?"

We did.....

"You can wear your PE kit on PE days all year round."



COLD WEATHER REMINDER

As the weather has turned colder and temperatures continue to drop, please ensure your child comes to school with a warm coat each day. We want all children to stay comfortable and safe during their time at school.

Thank you for your support and cooperation.



Successful job search techniques



National Careers Service: Where to find job vacancies

Use multiple strategies to secure a job...

Network

Contacts

Speculative applications

Recruitment agencies

Employer websites

Job search websites

Job fairs

Email job alerts

Social media

Sector specific sites

Notice boards

log in to learn more at www.morrisby.com





EXTRA CURRICULAR PROGRAMME TERM 3

This term, our extracurricular programme is full of exciting opportunities, with something to suit everyone's interests. There are sports, creative clubs and new activities to try out. Joining in is not just about fun, it's also a chance to discover new talents, meet different people, and grow in confidence.

Trying new things is especially valuable because it helps you step outside your comfort zone. You may uncover hidden skills you didn't know you had, or find a passion that could shape your future. It also teaches resilience, problem-solving, and teamwork skills that are useful both in and out of school.

Most importantly, extracurricular activities bring balance to your life. They give you a break from classroom learning while still helping you develop in meaningful ways. Whether you continue with something familiar or try something completely new, you'll gain experiences and memories that will last well beyond this term.

Click the image below to see what is happening this term!



ATTENDANCE MATTERS

TOTAL NUMBER OF DAYS ABSENT IN A SCHOOL YEAR	ATTENDANCE RATE %	ACTUAL ATTENDANCE	LESSONS LOST
0	100%	190 DAYS	0
10	95%	180 DAYS	50
20	90%	170 DAYS	100
30	85%	160 DAYS	150
40	80%	150 DAYS	200



ABOVE 95% ATTENDANCE =
VERY GOOD CHANCE OF 5 GCSEs

ABOVE 94% ATTENDANCE =
GOOD CHANCE OF 5 GCSEs

ABOVE 92% ATTENDANCE =
FAIR CHANCE OF 5 GCSEs

ABOVE 90% ATTENDANCE =
LESS THAN 50% CHANCE OF 5 GCSEs

88% ATTENDANCE =
LESS THAN 35% CHANCE OF 5 GCSEs
LESS THAN 85% ATTENDANCE =
LESS THAN 30% CHANCE OF 5 GCSEs

Work Experience Programme for Year 10 Students 2026

We are pleased to announce that our Work Experience Programme for Year 10 students, taking place from Monday 29th June to Friday 4th July 2026. This compulsory, week-long placement gives students the opportunity to step away from their usual school timetable and gain invaluable first-hand experience in the world of work.

To introduce the programme, we will be holding an assembly for all Year 10 students, where they will receive clear guidance on how to source, apply for, and follow up on work placements. This session will also offer practical advice on approaching employers and making the most of this experience.

Why Work Experience Matters

At this important stage of their education, work experience plays a vital role in helping students:

- Explore potential career paths and industries of interest
- Build independence and confidence through real-world experience
- Enhance CVs and future applications for sixth form, college, apprenticeships, or university
- Develop transferable skills, such as communication, teamwork, and problem-solving

Students are expected to arrange their own placement, ideally in a field that interests them. This process not only gives students a sense of ownership over their future, but also helps them develop essential skills for future job searches and applications.

Supporting Your Child

We ask for your support in encouraging your child to actively pursue a placement that aligns with their interests or future aspirations. Whether it's in healthcare, business, the arts, engineering, education, or another field, every experience will help broaden their understanding of the working world.

Students will be guided through the process in school, and I will be available to offer support and advice as needed.

This is a fantastic opportunity for our students to gain meaningful insight into the world beyond school, and we look forward to seeing the positive impact it will have on their confidence, motivation, and future goals.

Mrs Priestley
Careers Support Co-ordinator



The Abbey School

is proud to be a part of
FAVERSHAM'S STORY!



We are **proud** of our strong connections with the community of Faversham and our involvement in local life.

Through partnerships with local organisations and participation in community initiatives, we encourage all of our students to **grow, contribute and succeed.**





SUPPORTING EXAM STRESS AND WELLBEING

As part of the Personal Development programme, our Year 11, 12 and 13 students have been provided with helpful resources from Kooth, an award-winning online mental health and wellbeing platform.

Kooth offers free, safe and anonymous support for young people, including:

- One-to-one chats with qualified counsellors,
- Helpful articles and wellbeing activities,
- Peer support through moderated discussion boards, and
- Tools to track mood and set personal goals.

With mock exams approaching next week, we know many students may be feeling more anxious. These resources are designed to help them manage stress, build resilience and maintain balance during the exam period.

How you can support at home:

- Encourage regular breaks, rest, and healthy routines.
- Listen without judgement — sometimes talking helps most.
- Remind them that effort and progress matter more than perfection.
- Visit www.kooth.com together to explore the support available.

We're incredibly proud of our students' dedication and will continue to provide both academic and emotional support throughout the exam season.



The Abbey
School

HIRE OUR FACILITIES

CLICK THE QR CODE TO BOOK NOW!



Consideration In The Community

Most of you are wonderful ambassadors of the school through your kind and considerate actions towards others in our local community, especially when travelling to and from school.

Remember it is **not** fair for anyone to be allowed to deliberately make life miserable for others. **We will never tolerate nasty behaviour, thoughtless actions or bullying towards those in our school or in the local community.** In school always ask an adult for help if you are being treated unkindly or if you feel frustrated about the way others are treating you. **In the community** we need to show we are caring and considerate towards those who live and work near the school, so everyone feels safe and happy when they meet Abbey students.

DO

Move aside on the pavement to allow to use it.

Speak using appropriate tone and at a sensible level to those you are with, using language that is not offensive or swearing.

Cross roads safely, using the bridge to navigate the A3 and by looking up and checking the traffic for all other streets where there are no pedestrian crossing facilities

Respect residents' property by walking on the pavements, keeping away from cars, bin, doors and driveways. Be polite to those who live near our school.

DO NOT

Monopolise the whole pavement space by walking in a group forcing elderly, those with prams or indeed anyone from the community into the road.

Shriek, shout, threaten or swear to those around you, be they friends, members of the public or students who attend other schools - this is intimidating behaviour brings our school into disrepute and this will be followed up and dealt with.

Run across the A3, this is a busy road with TWO speed cameras on it for a reason - the number of accidents. **DO NOT** become a statistic (injured or worse). Do not walk out directly in front of cars and expect them to stop.

Trespass onto people's property or cause damage to their property, if this happens residents should report this to the police, and we will always help the police identify who has caused the problem so they can take the action they need to (this could include prosecution for criminal damage or harassment etc).

CANTEEN MENU 2025/26

Click the images below to view the canteen menu for Term 3!





POETRY LIVE

Quick! Buy Poetry Live tickets before the closing date!

Apollo Victoria Theatre, London, on Thursday 13th February 2026.

This inspiring event brings GCSE poets to life – students will hear live readings, gain insight into exam texts, and take part in a Q&A with some of the UK's most celebrated contemporary poets.

Tickets: £38.33

Spaces are limited – book early to secure your place!

Don't miss this unforgettable opportunity to boost GCSE Literature skills and enjoy poetry in a whole new way!

#PoetryLive #AbbeyEnglish #GCSEReady #LoveLiterature

Sparx Maths Homework Help

Come and see Mr Sargeant in B13 at lunch time to get help logging in, help with your work, or some quiet time just to get your homework completed. All students welcome!

Year 7 and 11 - Monday lunch time
Year 8, 9 and 10 - Thursday lunch time

You can also use homework club (Mondays - Thursdays from 3:30pm in B13) to use the IT facilities to get your homework completed. The maths classrooms are in the same corridor if you need any help!

Remember, you can log in with your single sign-in Microsoft details. If you are having trouble logging in, check your capital letters, check for typing errors or come and see IT to reset your password. It is your responsibility to make sure you can log in.

STARS OF THE WEEK

Well done to the following students for collecting the most house points this week!
KEEP UP THE AMAZING WORK!



Honor O
Year 7
537HP



Connor B
Year 7
534HP



Lenny-Joe B
Year 7
566HP



Makayla O
Year 10
533HP

#WAKE UP WEDNESDAY

Celebrating Your Achievements



IN CASE YOU MISSED IT,
CLICK HERE TO SEE OUR PREVIOUS
NEWSLETTER!



Staggered Dismissal Times

Staggered dismissal times have now been replaced with afternoon line up on the playground. Each year will then be dismissed one at a time in no particular order. In the event of wet weather, afternoon line up will be cancelled and we will revert to dismissing each year group one at a time from their classrooms.



NO EXCUSE FOR ABUSE

At The Abbey School, we strive to create a **safe and secure** environment for the school community. Our school is a **welcoming and inclusive place** where we all show one another respect and look out for each other.

We will not tolerate any **threatening, abusive or violent** behaviour and action will be taken when necessary.



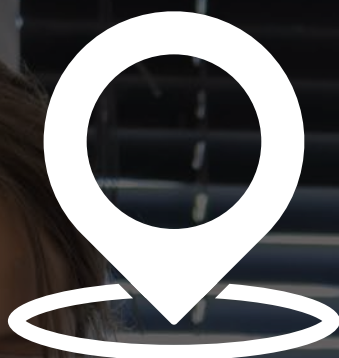

The Abbey School
Faversham
Kent
ME14 8RZ

www.theabbey-that.org.uk
info@abbeyschoolfaversham.co.uk
01795 532633

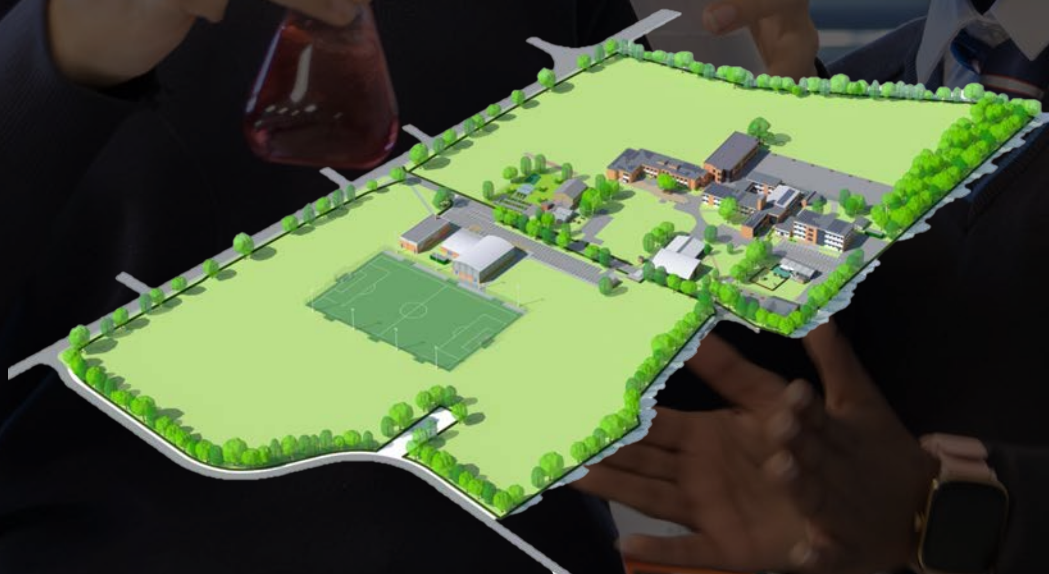

Attendance Office
01795 542477

attendance@abbeyschoolfaversham.co.uk

“BE THE BEST YOU CAN BE”



The Abbey
School